

LEVER TEST INDICATORS



ITEM: SERIE 513

Quality lever test Indicators (in compliance with the DIN 2270 standard). The structure is without friction that allows automatic reversal of the stylus direction of rotation. The rotating bevel and crystal, built in a single piece increase resistance to water and dust. Anti-reflective crystal with anti-scratch coating. Rotable bezel for zero setting. High precision movement mounted on rubies and bearings, gears and pinions that guarantee fluid movements, silent, rapid and precise measurements. Ø 2mm hard metal sphere. Dovetail connection Ø 8mm

Tech. Code	Excursion mm	Measurement force N	Ø mm	Resolution mm	L1 mm	L2 mm
D2320084021	0,8	0,01 ± 0,3	40	0,01	20,9	17,4

VERTICAL LEVER TEST INDICATORS



ITEM: SERIE 513

Quality lever test Indicators (in compliance with the DIN 2270 standard). The structure is without friction that allows automatic reversal of the stylus direction of rotation. The rotating bevel and crystal, built in a single piece increase resistance to water and dust. Anti-reflective crystal with anti-scratch coating. Rotable bezel for zero setting. High precision movement mounted on rubies and bearings, gears and pinions that guarantee fluid movements, silent, rapid and precise measurements. Ø 2mm hard metal sphere. Dovetail connection Ø 8mm.

Tech. Code	Excursion mm	Measurement force N	Diameter mm	Resolution mm	L1 mm	L2 mm
D2325084021	0,8	0,01 ± 0,3	40	0,01	20,9	17,4

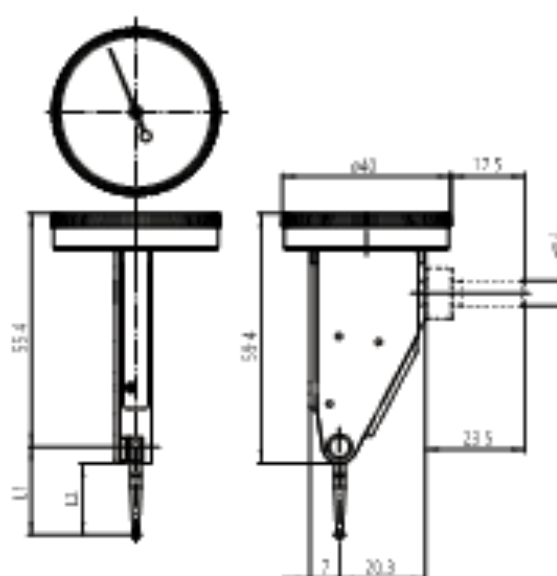

ALPAM LEVER TEST INDICATORS



ON-LINE
MANUAL

ITEM: CB052

High quality and reliability dial lever test indicator, swiss made components (according to DIN 2270). Rotable bezel for zero setting. Dove tail snug. Carbide ball stylus Ø 2 mm.

Tech. Code	Excursion mm	Diameter mm	Resolution mm	Lever L mm
D2316022913	0.2	29	0.002	13
D2316023813		38		
D2316082912	0.8	29	0.01	12
D2316082934		29		34
D2316083812		38		12
D2316083834		38		34

